

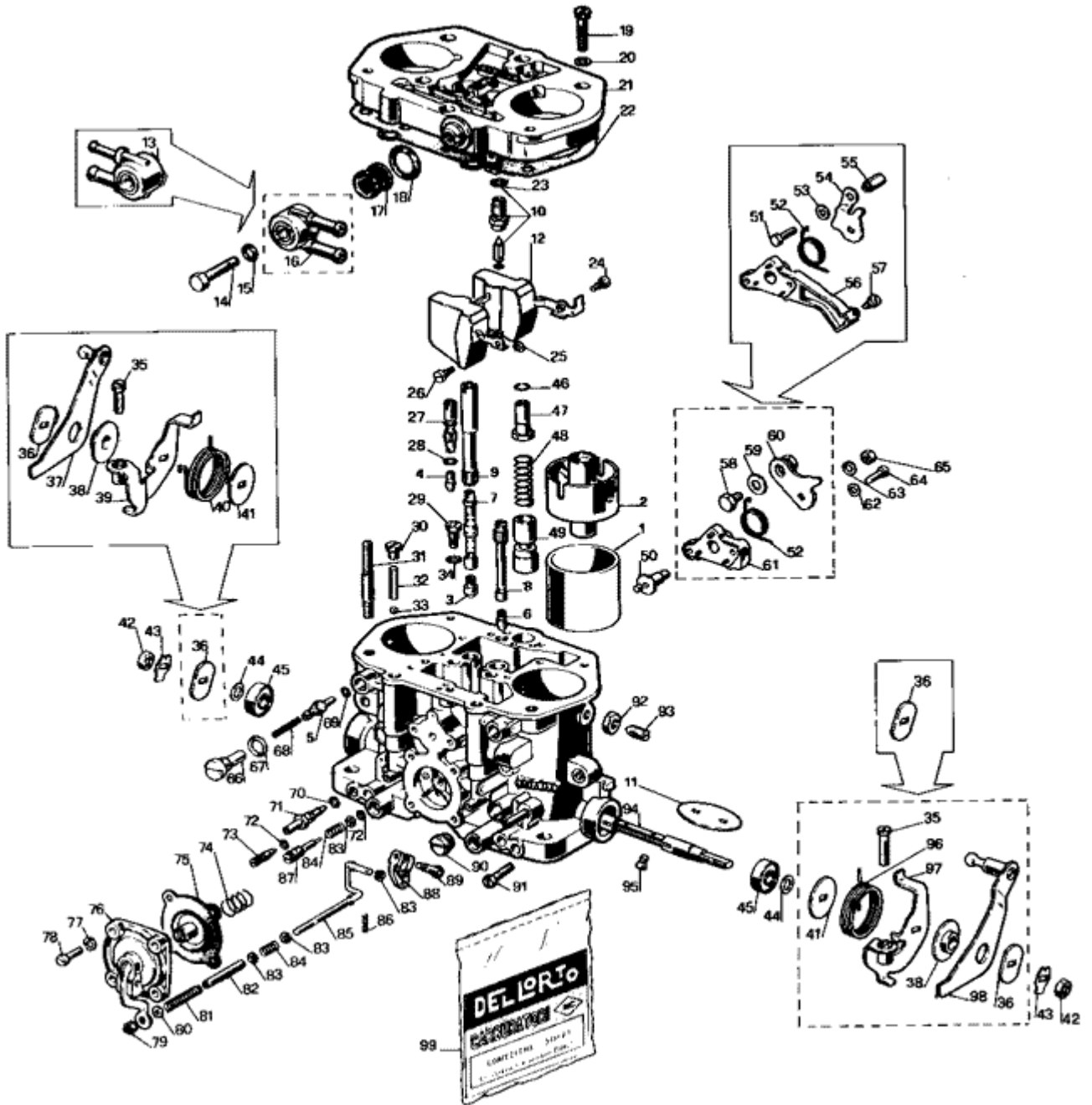

# Sør-Rogaland VW-KLUBB

Mekketips

## DRLA PARTS LIST & DIAGRAM



**Diag Part****Diag Part**

No.	No.	Description	Sizes/options available	No.	No.	Description	Sizes/options available
1	10527	DRLA36/40 Choke (Venturi)	26,28,30,31,32,33,34,36	43	6581	Spindle nut lock washer	
1	10758	DRLA45 Choke	32,34,36,38,39	44	7537	Spring washer	
1	11486	DRLA48 Choke	38,39,40,41,42	45	7490	Spindle bearing	
2	10078	DRLA 40 Auxiliary venturi	No longer available	46	10353	Retaining clip	
2	10527	DRLA45 Auxiliary venturi	No longer available	47	10135	Nut	
2	11487	DRLA48 Auxiliary venturi	No longer available	48	7413	Choke return spring	
3	7484	Main jet	85,90,95,100,102,105,108,110,	49	10252	Choke piston	
3		110 to 190 in steps of 1,	190,192,195,198...210-240 in 5's	50	10137	Choke actuator cam	
4	7644	Idle jet	32-82 in 1's	51	7062	Choke cable bolt	
5	10927	Pump jet	30,33,35,38,40,42,45,48,50,55,60	52	10156	Return spring	
6	3315	Starter jet	40-90 in 5's	53	6850	Choke cable washer	
7	9164	Main emulsion tube	No's 1,2,3,4	54	10110	Drive link	
8	7482	Starter emulsion tube	No's 1,2,3,4	55	6432	Choke cable nut	
9	7485	Air corrector	80,90,100,110,115,120,125,130,135	56	10231	Cover plate	
9			140,142.5-202.5 in 2.5's 205-250.	57	9174	Set screw	
9	10304	Tall air corrector jet	160,170,175,180,190,000	58	10140	Choke cable bolt	
10	10305	Needle valve (metal)	150,170,200,225	59	7231	Choke washer	
10	10375	Needle valve turbo (viton)	150,170,200,225 cross drilled	60	10817	Choke lever	
10	8649	Needle valve, viton tipped	250,270,300,350,400 cross drilled	61	10311	Choke cover	
11	10133	Throttle butterfly DRLA 36		62	5011	Lock washer	
11	7481	Throttle butterfly DRLA 40		63	4957	Lock washer	
11	8010	Throttle butterfly DRLA 45		64	10253	Screw	
11	8563	Throttle butterfly DRLA 48		65	2906	Nut	
12	10090	Float		66	10928	Pump jet holder	
13	10097	Fuel banjo, return 11mm bolt	Carb details required.	67	6426	Pump jet holder fibre washer	
13	12393	Fuel banjo, return 16mm bolt	Carb details required.	68	10748	Pump jet Filter/spring	
14	10132	11mm banjo bolt	Carb details required.	69	6173	O ring	
14	12390	16mm banjo bolt	Carb details required.	70	7571	O ring	
15	10134	11 mm banjo seal		71	10138	Manometer fitting	
15	7662	16mm banjo bolt seal		72	8678	O ring	
16	10096	Fuel banjo, double 11mm bolt		73	9926	Air bleed screw	
17	1419	Fuel Filter		74	9663	Pump diaphragm spring	

18	10570	Banjo bolt seal			75	10182	Pump diaphragm
19	6430	Top cover screw			76	10256	Pump cover plate
20	4957	Lock washer			77	5011	Lock washer
21	10066	Top cover	Carb details required.		78	6429	Screw
22	10092	Top cover gasket			79	10315	Lock nut
23	6288	Needle seat sealing washer			80	10340	Retaining washer
24	10154	Float hinge screw			81	10332	Spring
25	8498	Retaining clip			82	10331	Sleeve
26	10339	Float hinge screw			83	8260	Retaining washer
27	10738	Idle jet holder			84	9336	Spring
28	7540	Sealing O ring			85	10316	Pump rod
29	7542	Pump non-return valve			86	10686	Retaining clip
30	7513	Cap screw			87	9656	Mixture screw
31	10630	Top cover stud			88	10153	Pump rod clamp
32	7636	Pump jet weight			89	7667	Pump rod clamp screw
33	6415	Pump jet ball bearing			90	8857	Progression blanking cap
34	7540	O ring			91	9754	Screw
35	9754	Throttle stop screw			92	6423	Lock nut
36	7958	Spindle end cover			93	7507	Venturi grub screw
37	10230	Linkage drive arm			94	10790	Butterfly spindle
38	10142	Step washer			95	6416	Throttle butterfly screw
39	10184	Throttle lever			96	10157	Return spring
40	10158	Throttle return spring			97	10183	Throttle lever
41	10130	Washer			98	10229	Throttle lever
42	6423	Spindle nut			99	52534	Gasket set
DHLASK	Service kit ( 2 carbs)	40/45/48		{Viton needle valves, pump diaphragms}			
TURBOSK	Turbo service kit (2 carbs)	40/45		{gasket pack,throttle return springs,filters}			
	Ram pipes (40 or 45/48)			14/20/30mm long			
8559	Standard ram pipe DHLA 45/48			48mm long			
8257	Standard ram pipe DHLA 40			43mm long			
STUDS	Manifold studs						
NYLOCK	Nylock nuts for studs						
STUDS	Manifold studs						
NYLOCK	Nylock nuts for studs						